

ASME BPE Reducering Excentrisk med svetsändar

ASME BPE är en standard för Farmaceutisk, bioteknisk och andra industrier med hygienkrav.

DB0937
140211

Rör i ASME BPE standard, i Syrafast AISI 316L stål.

Materialcertifikat enligt EN 10204-3.1B

Ytfinhet enligt tabell nedan

Reducerande Excentrisk med svetsändar, TL32 (2009) (BPE# DT-4.1.3-1(a))

Rör YD Tum	A Tum		Artikelnummer - *
3/4" x 1/2"	4"		60705-*
1" x 1/2"	4-1/2"		60706-*
1" x 3/4"	4"		60707-*
1-1/2" x 1/2"	•		60703-*
1-1/2" x 3/4"	5"		60704-*
1-1/2" x 1"	5"		60705-*
2" x 1/2"	•		60706-*
2" x 3/4"	•		60707-*
2" x 1"	7-1/4"		60708-*
2" x 1-1/2"	5-1/4"		60709-*
2-1/2" x 1/2"	•		60710-*
2-1/2" x 3/4"	•		60711-*
2-1/2" x 1"	•		60712-*
2-1/2" x 1-1/2"	7-1/4"		60713-*
2-1/2" x 2"	5-1/2"		60714-*
3" x 1"	•		60715-*
3" x 1-1/2"	9-1/4"		60716-*
3" x 2"	7-1/2"		60717-*
3" x 2-1/2"	5-1/2"		60718-*
4" x 1"	•		60719-*
4" x 1-1/2"	•		60720-*
4" x 2"	11-3/4"		60721-*
4" x 2-1/2"	9-3/4"		60722-*
4" x 3"	7-3/4"		60723-*
6" x 3"	10"		60724-*
6" x 4"	10"		60725-*

• = Finns inte i ASME BPE. Ring för dimension.

För andra dimensioner, kontakta Saniflex

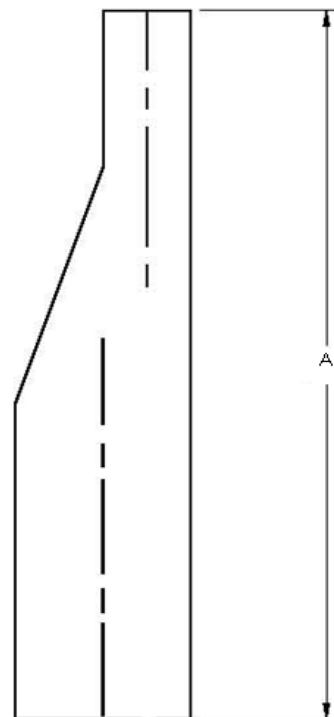

Reducerande Excentrisk med svetsändar, TL32 (2012) (BPE# DT-4.1.3-1(b))

Rör YD Tum	A Tum		Artikelnummer - *
3/4" x 1/2"	2-1/8"		60705N-*
1" x 1/2"	2-1/2"		60706N-*
1" x 3/4"	2-1/2"		60707N-*
1-1/2" x 3/4"	3"		60704N-*
1-1/2" x 1"	2-1/2"		60705N-*
2" x 1"	3-3/8"		60708N-*
2" x 1-1/2"	2-1/2"		60709N-*
2-1/2" x 1-1/2"	3-3/8"		60713N-*
2-1/2" x 2"	2-1/2"		60714N-*
3" x 1-1/2"	4-1/4"		60716N-*
3" x 2"	3-3/8"		60717N-*
3" x 2-1/2"	2-5/8"		60718N-*
4" x 2"	5-1/8"		60721N-*
4" x 2-1/2"	4-1/4"		60722N-*
4" x 3"	3-7/8"		60723N-*
6" x 3"	7-1/4"		60724N-*
6" x 4"	5-5/8"		60725N-*

För 1" TC enligt A typ eller andra dimensioner, kontakta saniflex

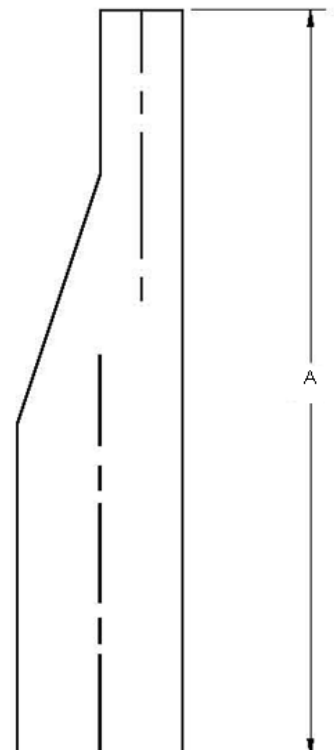

Ytfinish	ID		YD		Tillägg *
	µm	Polering	µm	Polering	
SF1	0,51	Mekanisk	opolerad	-	-3
SF1	0,51	Mekanisk	0,81	Mekanisk	-7
SF4	0,38	Elektropol.	opolerad	-	-3EP
SF4	0,38	Elektropol.	0,81	Mekanisk	-7EP

Andra ytfinheter kan ordnas mot kundspecifikationer.

saniflex ab