

ASME BPE T - Stycke Reducerande med TC

ASME BPE är en standard för Farmaceutisk, bioteknisk och andra industrier med hygienkrav.

DB0940
140211

Rör i ASME BPE standard, i Syrafast AISI 316L stål.

Materialcertifikat enligt EN 10204-3.1B

Ytfinhet enligt tabell nedan

T-stycke, reducerande med 3xTC, 7RMP (BPE# DT-4.1.2-8)

Rör YD Tum	A Tum	B Tum		Artikelnummer - *
3/4" x 1/2"	2-1/2"	2-1/2"		60485-*
1" x 1/2"	2-5/8"	2-5/8"		60486-*
1" x 3/4"	2-5/8"	2-5/8"		60487-*
1-1/2" x 1/2"	2-7/8"	2-7/8"		60488-*
1-1/2" x 3/4"	2-7/8"	2-7/8"		60489-*
1-1/2" x 1"	2-7/8"	2-7/8"		60490-*
2" x 1/2"	3-3/8"	3-1/8"		60491-*
2" x 3/4"	3-3/8"	3-1/8"		60492-*
2" x 1"	3-3/8"	3-1/8"		60493-*
2" x 1-1/2"	3-3/8"	3-1/8"		60494-*
2-1/2" x 1/2"	3-5/8"	3-3/8"		60495-*
2-1/2" x 3/4"	3-5/8"	3-3/8"		60496-*
2-1/2" x 1"	3-5/8"	3-3/8"		60497-*
2-1/2" x 1 1/2"	3-5/8"	3-3/8"		60498-*
2-1/2" x 2"	3-5/8"	3-3/8"		60499-*
3" x 1/2"	3-7/8"	3-5/8"		60500-*
3" x 3/4"	3-7/8"	3-5/8"		60501-*
3" x 1"	3-7/8"	3-5/8"		60502-*
3" x 1-1/2"	3-7/8"	3-5/8"		60503-*
3" x 2"	3-7/8"	3-7/8"		60504-*
3" x 2-1/2"	3-7/8"	3-7/8"		60505-*
4" x 1/2"	4-3/4"	4-1/8"		60506-*
4" x 3/4"	4-3/4"	4-1/8"		60507-*
4" x 1"	4-3/4"	4-1/8"		60508-*
4" x 1-1/2"	4-3/4"	4-1/8"		60509-*
4" x 2"	4-3/4"	4-3/8"		60510-*
4" x 2-1/2"	4-3/4"	4-3/8"		60511-*
4" x 3"	4-3/4"	4-3/8"		60512-*
6" x 4"	7-1/8"	5-3/4"		60513-*

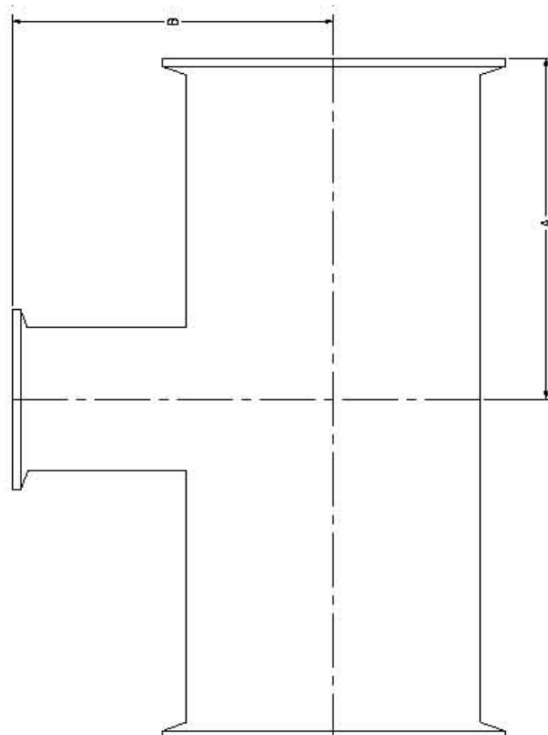

För 1" TC enligt A typ eller andra dimensioner, kontakta saniflex

Ytfinish	ID		YD		Tillägg *
	µm	Polering	µm	Polering	
SF1	0,51	Mekanisk	opolerad	-	-3
SF1	0,51	Mekanisk	0,81	Mekanisk	-7
SF4	0,38	Elektropol.	opolerad	-	-3EP
SF4	0,38	Elektropol.	0,81	Mekanisk	-7EP

Andra ytfinheter kan ordnas mot kundspecifikationer.